

Lever Chain Hoist LA Series

FEATURES

- **Dual rated with more choices of capacity**
- **Hook blocks are bolted allowing easy disassembly for complete hook inspection**
- Lightweight and durable all steel construction with powder coated finish and plated external components to resist corrosion
- Premium Grade 80 Zinc plated alloy load chain manufactured in Germany, Austria or Japan
- Self adjusting double pawl disk type mechanical load brake insures control
- Horseshoe chain guard allows operation in any orientation
- **Optional Overload Protection is new design one directional clutch that will only slip in the lift direction**
- Meets: ASME/ANSI B30.16, OSHA, NASA-STD-8719.9 and EU Directives: 98/37/EC
- ATEX rated II 3 GD c IIB 50° C X for limited use in Hazardous Environments

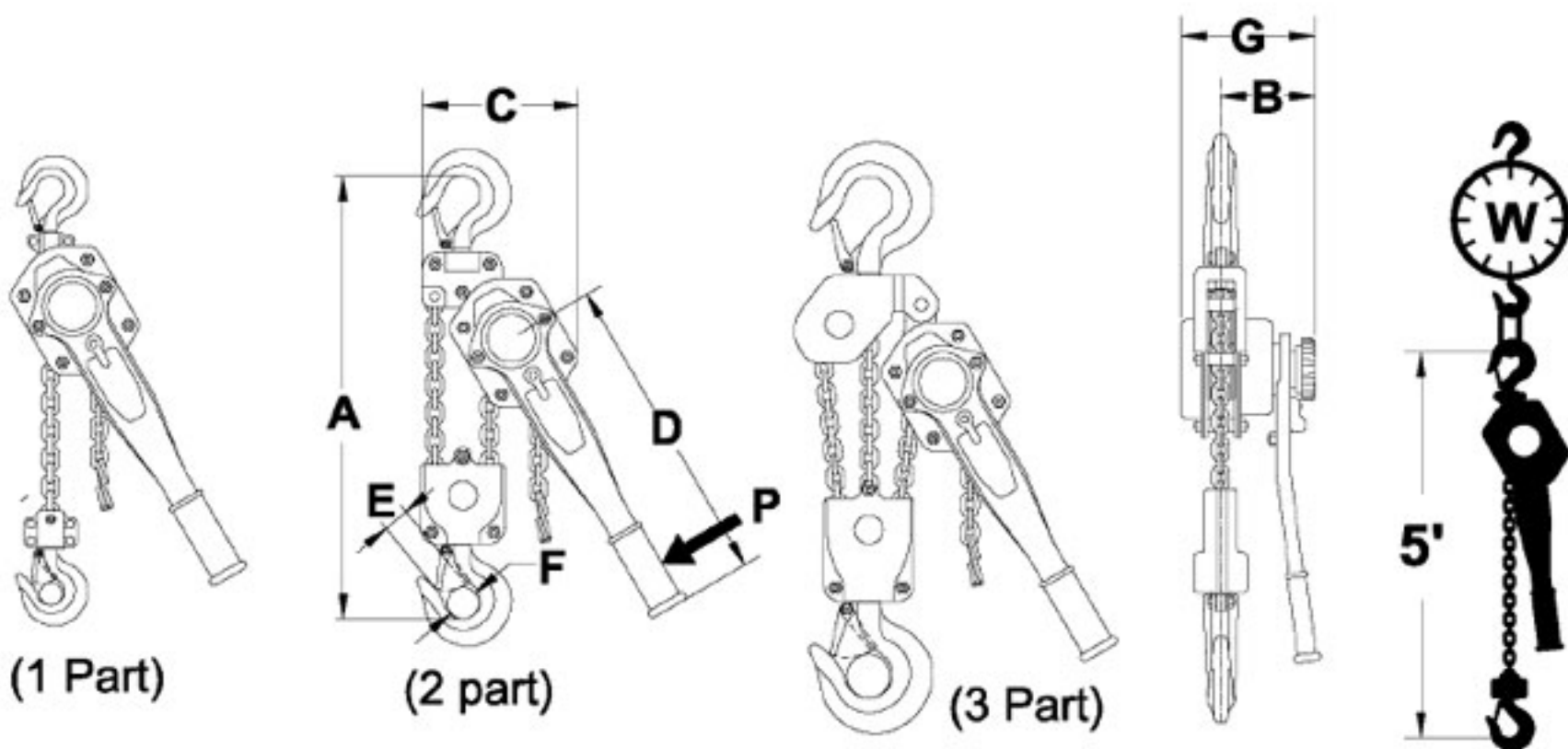

Working Load Limit (WLL)				SPECIFICATIONS (Inches and pounds)												
Bass Model	US Ton	Metric Tonne	*Min. Lbs	Load Kg	Chain	Parts	A"	B"	C"	D"	E"	F"	G"	P (lbs)	W (lbs)/ Ft. Lift	W(1) (lbs) 5 F.t Lift
LA008	3/4+	0.8	44	20	C6X18Z	1	13	4	5.2	11	1	1	6	41	0.54	14.9
LA010	1+	1	44	20	C6X18Z	1	13	4	5.2	12	1	1	6	51	0.54	15.3
LA016	1 3/4	1.6	70	32	C7X21Z	1	16	4	5.7	14	1.1	1	7	56	0.74	24.1
LA020	2 1/4	2	88	40	C8X24Z	1	18	5	7.6	14	1.4	1	8	56	0.92	36.2
LA025	2 3/4	2.5	110	50	C9X27Z	1	19	5	7.6	14	1.4	1	8	63	1.25	37.9
LA032	3 1/2	3.2	141	64	C10X28Z	1	21	5	7.8	17	1.5	1	8	72	1.5	44.8
LA063	7	6.3	278	126	C10X28Z	2	25	5	9.1	17	1.7	2	8	74	3	66.3
LA090	10	9	396	180	C10X28Z	3	29	5	13	17	1.7	2	8	76	4.5	110.6

(1) Shipping weight can be estimated by adding approx., 15% to "W" hanging weight
***Minimum Load** is the load required to activate the automatic load brake

The break will stop a load even if the operator leaves the unit in free chain mode and in neutral, in a similar way as a seat belt reacts
Standard lift = 5, 10, 15 and 20 Ft. Custom lifts are available

Option: V = Overload Protection, **new design one-way operation will lower any load.**

S = Shipyard Hooks include top and bottom Available for 1.5 & 3t only

Order by descriptive model number:

Example: Model **LA032-20V**

Base Model
LA032

-Lift
-20

Option
V

V= With Overload Protection

S = With shipyard hooks include top & bottom (1.5 & 3t only)